

SIGN	DATE	DESCRIPTION	APPROVER
			Tony

THIS IS CAD DRAWING, DO NOT REVISE MANUALLY!!!

SPECIFICATIONS

RATINGS

Current Rating: 1A
Voltage Rating: 200V AC(r.m.s.)
Temperature Range: -40°C ~ + 105°C
Contact Resistance: <20mΩ
Insulation Resistance: >500MΩ
Dielectric Withstanding Volt: 500V AC for 1 min

MATERIAL:

Body: PBT with 15% GF
Color: Black
Contact: Phosphor Bronze
Plating: 100u" Tin over 30u" Nickel
Flammability: UL94V-0

RoHS Compliant

A = 1.25 x No. of Spaces
B = A + 5.0
C = A + 2.66
* Available in 03 through 36 circuits

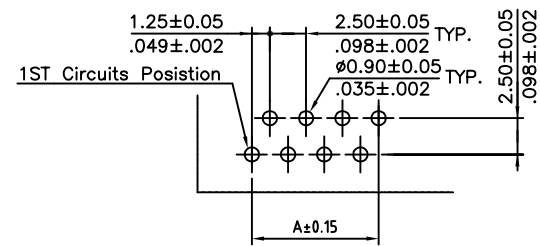
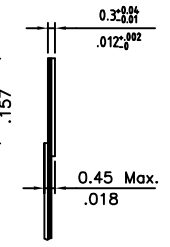
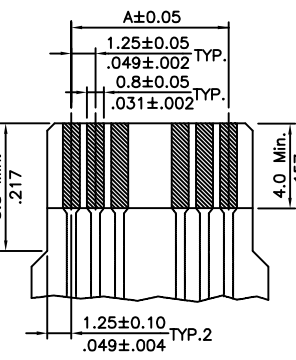
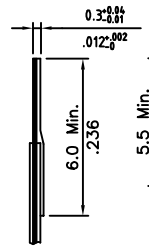
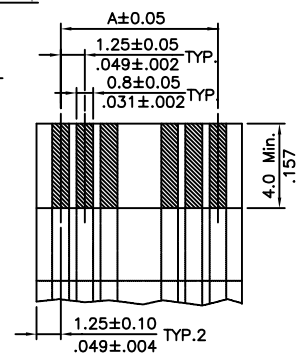
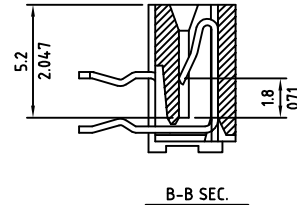
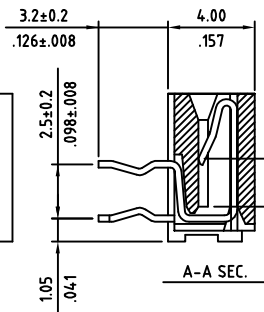
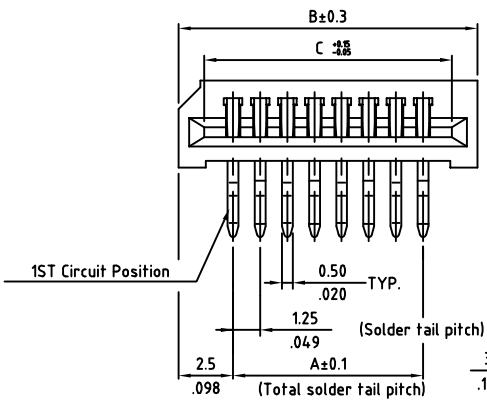

Recommended P.C. Board Layout

Part Number

FPC1252DXXRT5TU

of circuits
03 - 36

THESE DRAWINGS AND SPECIFICATIONS ARE THE PROPERTY OF ON-SHORE TECHNOLOGY, INC. AND SHALL NOT BE REPRODUCED, COPIED OR USED IN ANY MANNER WITHOUT THE PRIOR WRITTEN CONSENT OF ON-SHORE TECHNOLOGY, INC.



TITLE		FPC125 Series - 1.25mm thru hole LIFF FFC/FPC Right/Angle connector			
PART NO.	FPC1252DXXRT5TU	DWG NO.	FPC1252DXXRT5TU.DWG		
APPROVED	CHECKED	DESIGNED	DRAWN	4050	
Alex 2007.05.05	David 2007.05.05	Eisley 2005.05.05	Sandy 2007.05.05	Tolerance	
				UNIT: mm/inch	.X ±0.15/0.006
				SCALE: NONE	.XX ±0.10/0.004
				REV: A	.XXX ±0.05/0.002
SHEET: 01/02					