

# EDSTL951/X (5.0 mm) EDSTLZ951/X (5.08 mm)

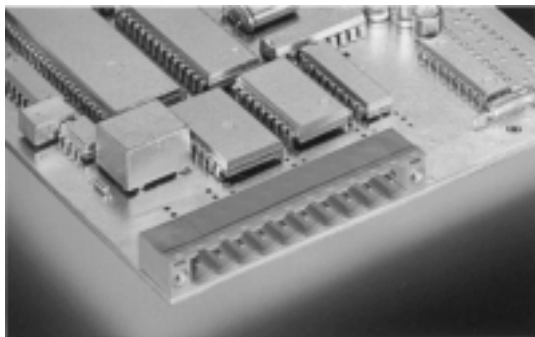

2-10 poles, Spacing 5.0 mm or 5.08 mm  
insert required no. of poles **X**  
How to order see page 5



### Ratings:

Rated Voltage	300 V	250 V
Rated Current	15 A	12 A (T60)
Rating Impulse Voltage/Dirt Level		4 kV/3

### Dimensions

Spacing	5.0 mm (5.08 mm)
PCB Hole Diameter	1.4 mm

### Materials

Insulating Material	PA/PBTP
Flammability Class	UL94 V-0
Temperature Range	-30°C/+105°C
Contact Pin	Cu

### Color

Green

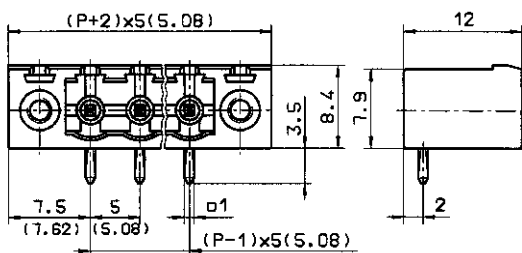

**P = No. of poles**