

| | | | |
|---|------|-------------|----------|
| SIGN | DATE | DESCRIPTION | APPROVER |
| | | | Tony |
| <i>THIS IS CAD DRAWING, DO NOT REVISE MANUALLY!!!</i> | | | |

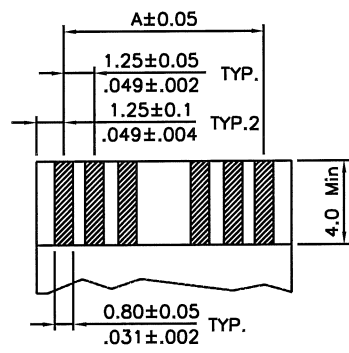

Accommodated FPC/FFC
(Thickness: 0.3mm ± 0.05)

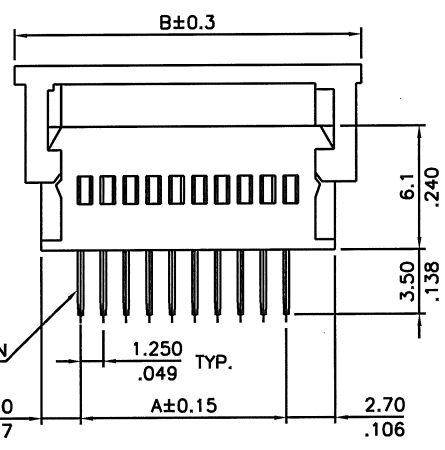
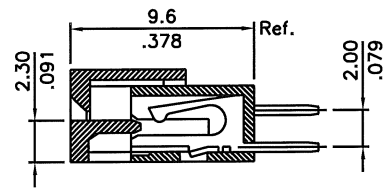
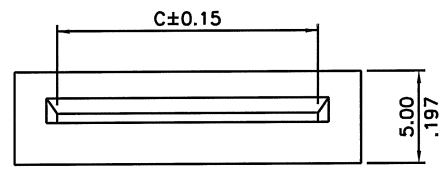
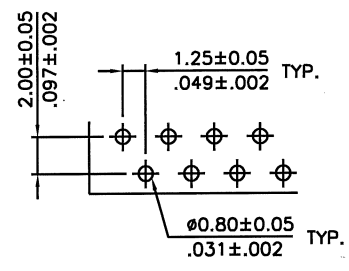

Recommended P.C. Board Layout

SPECIFICATIONS

RATINGS

- Current Rating: 1A
- Voltage Rating: 200V AC(r.m.s.)
- Temperature Range: -40°C ~ +105°C
- Contact Resistance: <20mΩ
- Insulation Resistance: >500MΩ
- Dielectric Withstanding Volt: 500V AC for 1 min

MATERIAL

- Body: Glass Filled Polyester
- Contact: Phosphor Bronze
- Flammability: UL94V-0
- Packaging: Tube
- Plating: Tin over Nickel

RoHS Compliant

- A = 1.25 * No. of Spaces
- B = A + 7.05
- C = A + 2.7
- * Available in 03 through 32 circuits

Part Number
FPC1251DXXVT5TU
of circuits
03 - 32

THESE DRAWINGS AND SPECIFICATIONS ARE THE PROPERTY OF ON-SHORE TECHNOLOGY, INC. AND SHALL NOT BE REPRODUCED, COPIED OR USED IN ANY MANNER WITHOUT THE PRIOR WRITTEN CONSENT OF ON-SHORE TECHNOLOGY, INC.



| | | | | | | |
|--------------------|---------------------|---|---------------------|--------|--|---|
| TITLE | | FPC 1.25mm, ZIF, FFC/FPC Vertical thru hole connector | | | | |
| PART NO. | FPC1251DXXDT5TU | DWG NO. | FPC1251DXXDT5TU.DWG | | | |
| APPROVED | CHECKED | DESIGNED | DRAWN | 4050 | | Tolerance |
| Alex 2006.01.18 | David 2006.01.16 | Eisley 2006.01.16 | Sandy 2006.01.14 | | | UNIT: mm/inch .X ±0.25/0.010 SCALE: NONE .XX ±0.15/0.006 .XXX ±0.08/0.003 |
| SHEET: 01/01 | | | | REV: A | | |