

SIGN	DATE	DESCRIPTION	APPROVER
			Tony

THIS IS CAD DRAWING, DO NOT REVISE MANUALLY!!!

### SPECIFICATIONS

#### RATINGS

- Current Rating: 1A
- Voltage Rating: 100V AC(r.m.s.)
- Temperature Range: -25°C ~ +85°C
- Contact Resistance: <20mΩ
- Insulation Resistance: >500MΩ
- Dielectric Withstanding Volt: 500V AC for 1 min
- Reflow Temperature: 230°C for 60 sec.  
260°C for 10 sec.

#### MATERIAL:

- Body: Glass Filled Nylon 6T
- Slider: PPS, 40% GF
- Contact: Copper Alloy, Tin plated
- Plating: Tin over Nickel
- Fixed Tab: Copper Alloy, Tin plated
- Flammability: UL94V-0

RoHS Compliant

A = 1.00 \* No. of Spaces  
 B = A + 8.0  
 C = A + 2.1  
 \* Available in 04 through 32 circuits

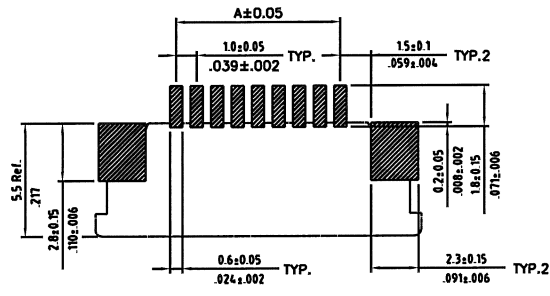
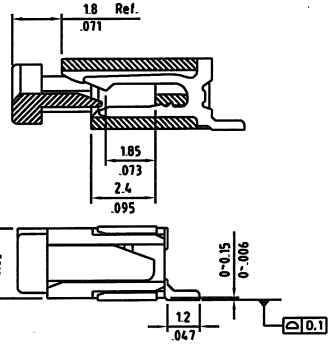
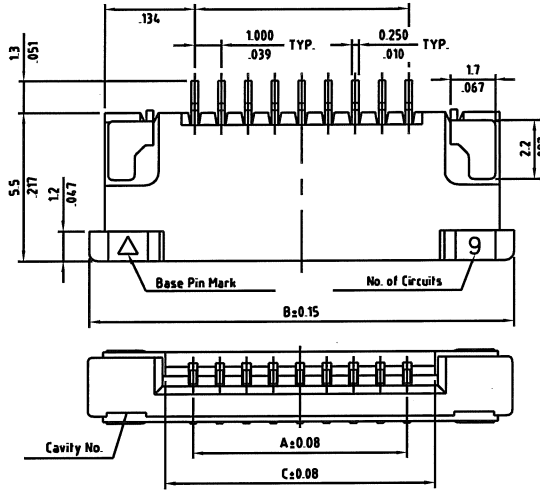

Solder Pad Pattern

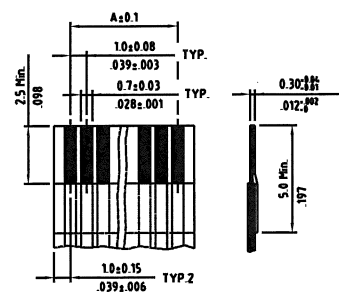

Accommodated FFC

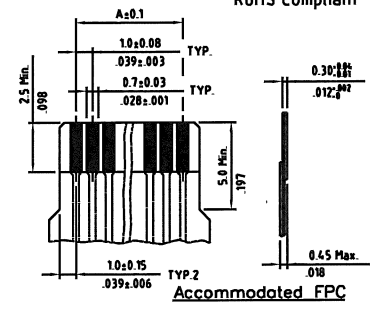

Part Number

FPC100ZXXSRU5XX

# of circuits  
04-32

Packaging  
 TU - tube  
 TR - tape/reel

THESE DRAWINGS AND SPECIFICATIONS ARE THE PROPERTY OF ON-SHORE TECHNOLOGY, INC. AND SHALL NOT BE REPRODUCED, COPIED OR USED IN ANY MANNER WITHOUT THE PRIOR WRITTEN CONSENT OF ON-SHORE TECHNOLOGY, INC.

<b>OST</b>		ON-SHORE TECHNOLOGY, INC.		
TITLE	FPC 1.00mm, ZIF, Upside contact, SMT			
PART NO.	FPC100ZXXSRU5XX	DWG NO.	FPC100ZXXSRU5XX.DWG	
APPROVED	CHECKED	DESIGNED	DRAWN	4050
Alex 2007.06.19	David 2007.06.19	Eisley 2007.06.19	Sandy 2007.06.19	Tolerance
				UNIT: mm/inch
				SCALE: NONE
				.X ±0.30/0.12
				.XX ±0.20/008
				.XXX ±0.10/004
SHEET: 01/01			REV: A	

SIGN	DATE	DESCRIPTION	APPROVER
			Tony
THIS IS CAD DRAWING, DO NOT REVISE MANUALLY!!!			

- NOTE :
- 10 sprocket hole pitch cumulative tolerance  $\pm 0.20$
  - Carrier camber is within 1 mm in 100 mm .
  - Material : Transparent Conductive Polystyrene Alloy (UP-5000) 100% recyclable.
  - All dimensions meet EIA-481-3 requirements.
  - Thickness :  $0.33 \pm 0.03$  mm.
  - Packing length per 22" reel : 75.0 Meters.
  - Component load per 13" reel : 2000 pcs.

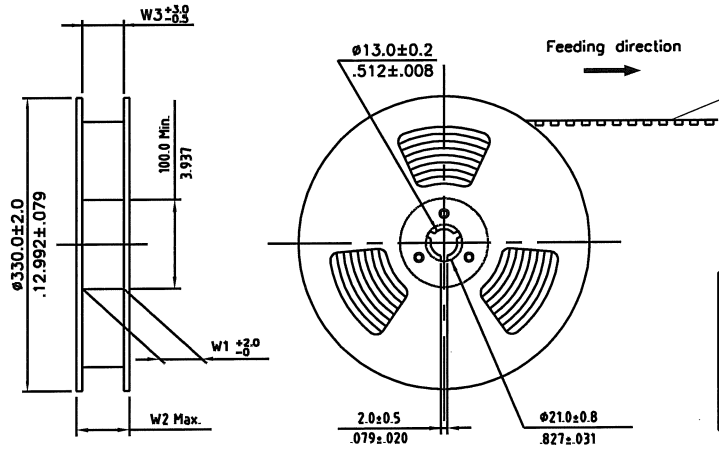

Circuits	Dimension				
	E	F	W1	W2	W3
04-8	24.0(.945)	-	24.5(.965)	30.5(1.201)	24.5(.965)
09-14	32.0(1.260)	28.40(1.118)	32.5(1.280)	38.5(1.516)	32.5(1.280)
15-25	44.0(1.732)	40.40(1.596)	44.5(1.752)	50.5(1.988)	44.5(1.752)
26-32	56.0(2.205)	52.40(2.062)	56.5(2.224)	62.5(2.460)	56.5(2.224)

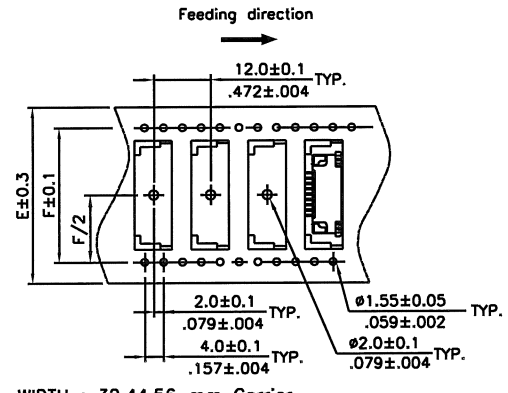
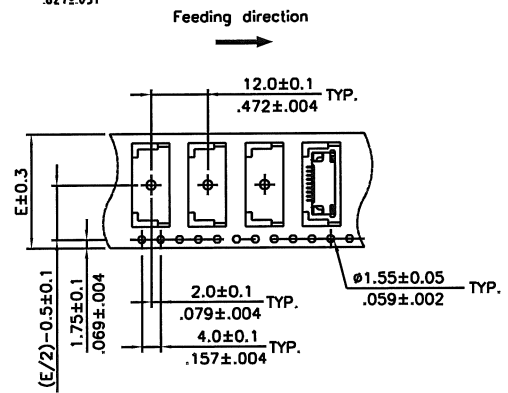
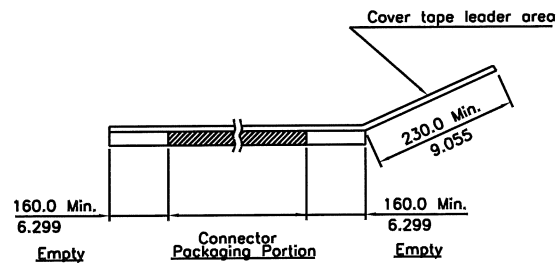

WIDTH : 24 mm Carrier

WIDTH : 32.44.56 mm Carrier

# OST ON-SHORE TECHNOLOGY, INC.

THESE DRAWINGS AND SPECIFICATIONS ARE THE PROPERTY OF ON-SHORE TECHNOLOGY, INC. AND SHALL NOT BE REPRODUCED, COPIED OR USED IN ANY MANNER WITHOUT THE PRIOR WRITTEN CONSENT OF ON-SHORE TECHNOLOGY, INC.

TITLE		FPC100Z Series Side Entry - REEL PACKAGING			
PART NO.	FPC100Z	DWG NO.	FPC100Z.DWG		
APPROVED	CHECKED	DESIGNED	DRAWN	4050	
Alex 2007.05.05	David 2007.05.05	Eisley 2005.05.05	Sandy 2007.05.05	Tolerance	
				UNIT: mm/inch	X $\pm 0.15/006$
				SCALE: NONE	.XX $\pm 0.10/004$
				SHEET: 02/02	.XXX $\pm 0.05/002$
				REV: A	