

SIGN	DATE	DESCRIPTION	APPROVER
			Tony

THIS IS CAD DRAWING, DO NOT REVISE MANUALLY!!!

SPECIFICATIONS

RATINGS

Current Rating: 1A
Voltage Rating: 100V AC (r.m.s.)
Temperature Range: -25°C ~ +85°C
Contact Resistance: <20mΩ
Insulation Resistance: >500MΩ
Dielectric Strength: 500V AC for 1 minute

MATERIAL:

Body: Glass Filled Nylon 6T
Contact: Phosphor Bronze, Tin plated
Flammability: UL94V-0
Color: Brown
Packaging: Tube

RoHS Compliant

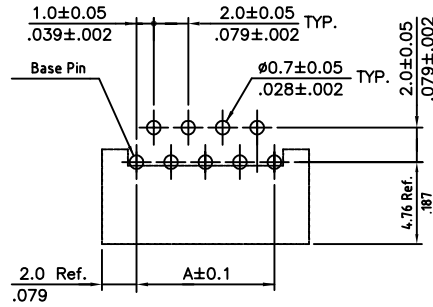
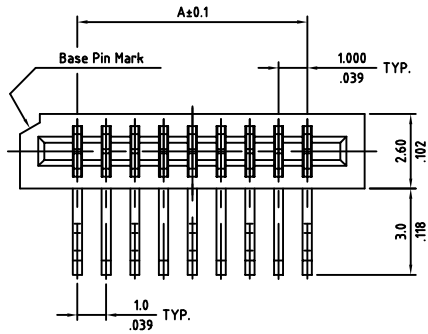

Recommended P.C. Board Layout

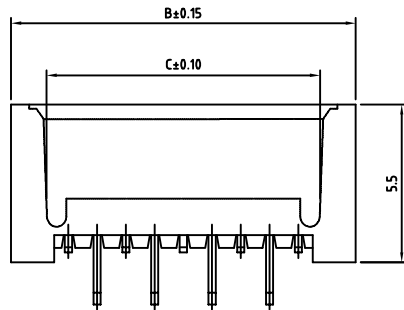

A = 1.00 * No. of Spaces
B = A + 4.0
C = A + 2.1

* Available in 04 through 32 circuits

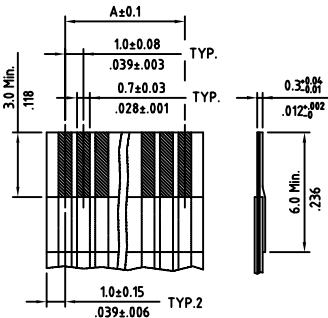
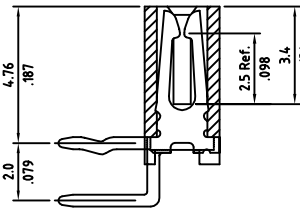

Accommodated FFC

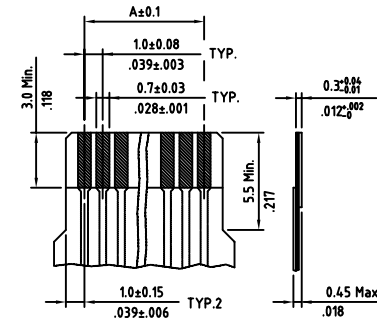

Accommodated FPC

Part Number

FPC100DXXRT5TU

of circuits



THESE DRAWINGS AND SPECIFICATIONS ARE THE PROPERTY OF ON-SHORE TECHNOLOGY, INC. AND SHALL NOT BE REPRODUCED, COPIED OR USED IN ANY MANNER WITHOUT THE PRIOR WRITTEN CONSENT OF ON-SHORE TECHNOLOGY, INC.

TITLE	1.00mm, LIF, Right/angle FPC/FFC			DWG NO. FPC100DXXRT5TU.DWG	
PART NO.	FPC100DXXRT5TU			4050	
APPROVED	CHECKED	DESIGNED	DRAWN	Tolerance	
Alex 2007.09.22	David 2007.09.22	Eisley 2007.09.22	Sandy 2007.09.22	UNIT: mm/inch SCALE: NONE SHEET: 01/01	
				.XX ±0.15/0.006 .XXX ±0.10/0.004 .XXX ±0.05/0.002	
				REV: A	