

SIGN	DATE	DESCRIPTION	APPROVER
		THIS IS CAD DRAWING, DO NOT REVISE MANUALLY!!!	Tony

SPECIFICATIONS

RATINGS

Current Rating: 0.4A
Voltage Rating: 50V AC(r.m.s.)
Temperature Range: -25°C ~ +85°C
Contact Resistance: <30mΩ
Insulation Resistance: >100MΩ
Dielectric Withstanding Volt: 250V AC for 1 min

MATERIAL:

Body: Glass Filled Polyamide, Color Ivory
Slider: Nylon 46 with 40% GF, Color Natural
Contact: Phosphor Bronze with Matte Tin plating
Plating: 120u" Tin over 30u" Nickel
Fixed Tab: Brass with Tin plating
Flammability: UL94V-0

RoHS Compliant

Part Number

FPC0501XXV05XX0

of circuits
04 - 50

Packaging
TU - tube
TR - tape/reel

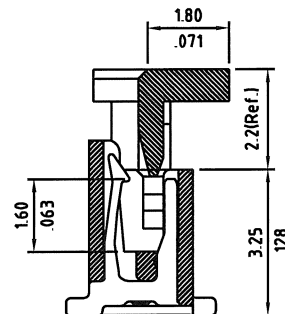
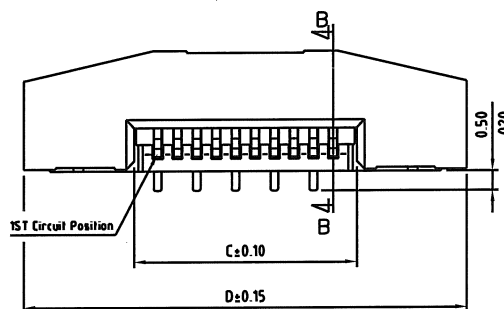

B-B SEC.

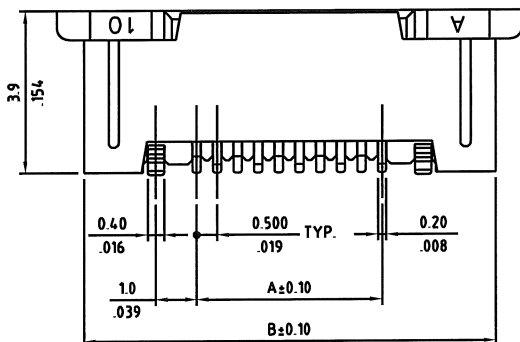

A = 0.50 x No. of Spaces
B = A + 5.5
C = A + 1.2
D = A + 6.8

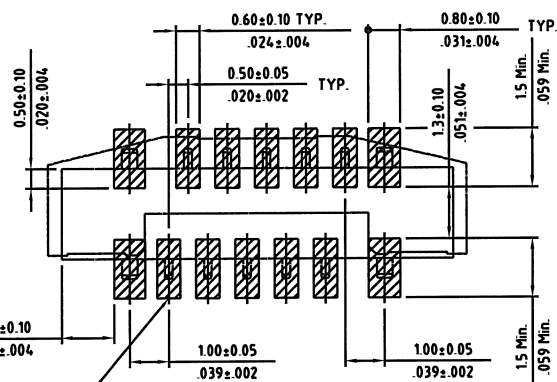
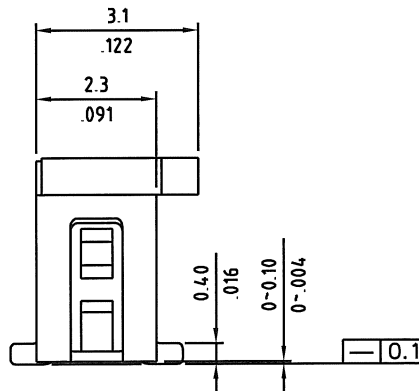

Solder Pad Pattern

THESE DRAWINGS AND SPECIFICATIONS ARE THE PROPERTY OF ON-SHORE TECHNOLOGY, INC. AND SHALL NOT BE REPRODUCED, COPIED OR USED IN ANY MANNER WITHOUT THE PRIOR WRITTEN CONSENT OF ON-SHORE TECHNOLOGY, INC.



TITLE		FPC0501 Series - 0.50mm SMT ZIF Vertical FFC/FPC connector			
PART NO.		FPC0501XXV05XX0		DWG NO. FPC0501XXV05XX0.DWG	
APPROVED		CHECKED	DESIGNED	DRAWN	4050
Alex 2007.09.03		David 2007.09.03	Eisley 2007.09.03	Sandy 2007.09.03	Tolerance
				UNIT: mm/inch X ±0.15/0.006	
				SCALE: NONE XX ±0.10/0.006	
				XXX ±0.05/0.002	
		SHEET: 01/02		REV: A	

SIGN	DATE	DESCRIPTION	APPROVER
			Tony
THIS IS CAD DRAWING, DO NOT REVISE MANUALLY!!!			

- NOTE :
- * Reel Material : HIPS
 - * Carrier Material : Clear, Conductive Polystyrene Alloy
 - * Cover Tape Material : Polyester
 - * Cover Tape Peel Strength : 0.1N - 1.3N
 - * Carrier camber is within 1mm in 100mm
 - * All dimensions meet EIA-481-2 & EIA-481-3 requirements.
 - * Quantity : Side Entry 2000/Reel Top Entry 1000/Reel

Circuits	Dimension					Packing (Reel/Caton)
	E	F	W1	W2	W3	
4-21	24.0(.945)	-	24.5(.965)	30.5(1.200)	24.5(.965)	9
22-31	32.0(1.260)	28.40(1.118)	32.5(1.280)	38.5(1.516)	32.5(1.280)	7
32-50	44.0(1.732)	40.40(1.596)	44.5(1.752)	50.5(1.988)	44.5(1.752)	5

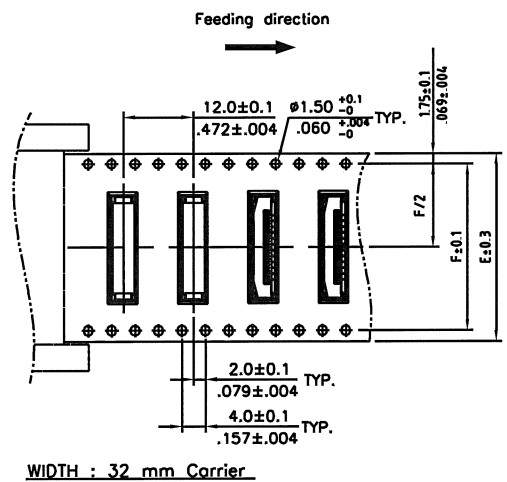
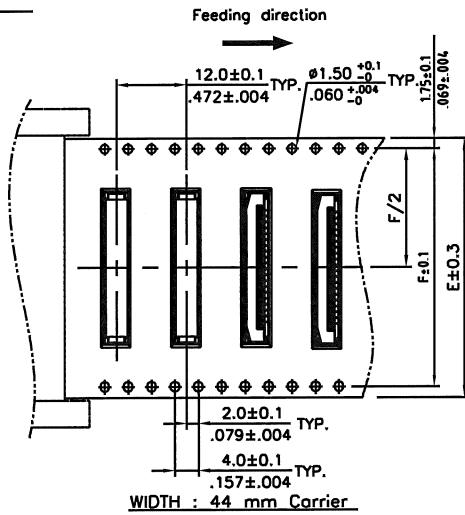
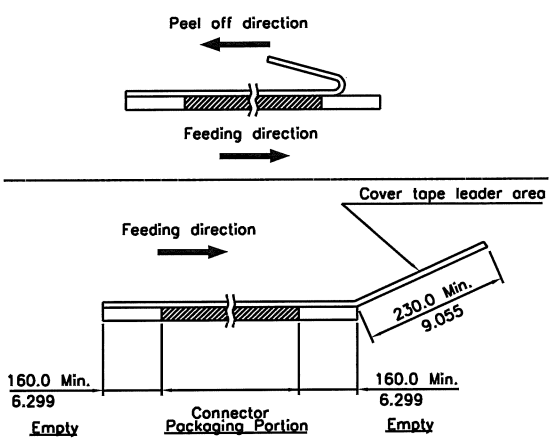
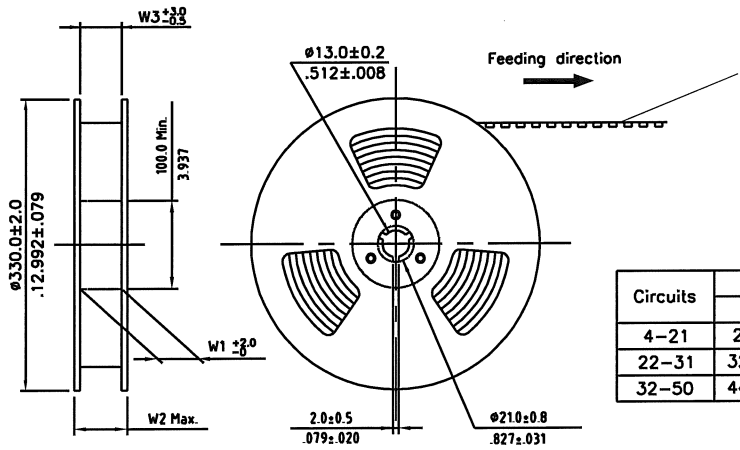

THESE DRAWINGS AND SPECIFICATIONS ARE THE PROPERTY OF ON-SHORE TECHNOLOGY, INC. AND SHALL NOT BE REPRODUCED, COPIED OR USED IN ANY MANNER WITHOUT THE PRIOR WRITTEN CONSENT OF ON-SHORE TECHNOLOGY, INC.

OST ON-SHORE TECHNOLOGY, INC.

TITLE		FPC0501 Series - 0.50mm SMT REEL PACKAGING			
PART NO.	FPC0501	DWG NO.	FPC0501.DWG		
APPROVED	CHECKED	DESIGNED	DRAWN	4050	
Alex 2007.05.05	David 2007.05.05	Eisley 2005.05.05	Sandy 2007.05.05	Tolerance	
				UNIT: mm/inch	.X ±0.15/0.006
				SCALE: NONE	.XX ±0.10/0.04
				REV: A	.XXX ±0.05/0.02
SHEET: 02/02					