

SIGN	DATE	DESCRIPTION	APPROVER
			Tony

THIS IS CAD DRAWING, DO NOT REVISE MANUALLY!!!

CIRCUITS	DIM.A	DIM.B	DIM.C
02	3.00(.118)	9.65(.380)	9.0(.354)
03	6.00(.236)	12.65(.498)	12.0(.472)
04	9.00(.354)	15.65(.616)	15.00(.591)
05	12.00(.472)	18.65(.734)	18.00(.709)
06	15.00(.591)	21.65(.852)	21.00(.827)
07	18.00(.709)	24.65(.970)	24.00(.945)
08	21.00(.827)	27.65(1.089)	27.00(1.063)
09	24.00(.945)	30.65(1.207)	30.00(1.181)
10	27.00(1.063)	33.65(1.325)	33.00(1.299)
11	30.00(1.181)	36.65(1.443)	36.0(1.417)
12	33.00(1.299)	39.65(1.561)	39.0(1.535)

SPECIFICATIONS

Body: Nylon 6T  
 Color: Black  
 Contact: Brass  
 Plating: Sn over Ni (Standard)  
 other plating available, may require MOQ  
 Flammability: UL94V-0  
 Current: 5A for AWG#20-22  
 4A for AWG#24  
 3A for AWG#26  
 2A for AWG#28  
 1A for AWG#30  
 Voltage: 250V AC(r.m.s.)  
 Dielectric Withstanding: 1500 VAC for one minute  
 Insulation Resistance: >1000 MΩ  
 Contact Resistance: <10 mΩ  
 Operating Temperature: -40°C ± 105°C

RoHS Compliant

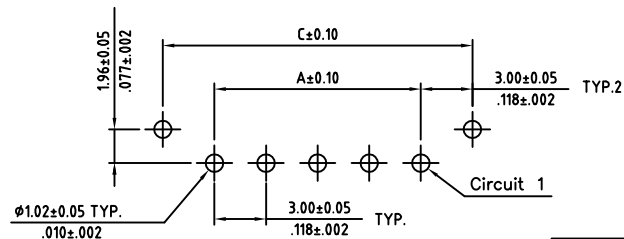
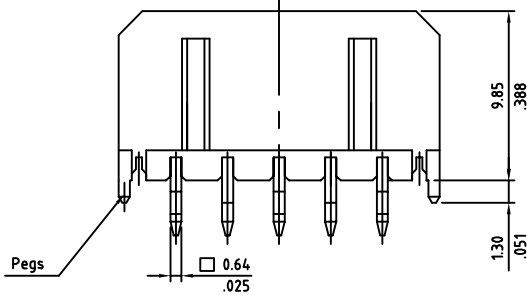
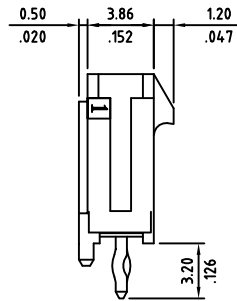
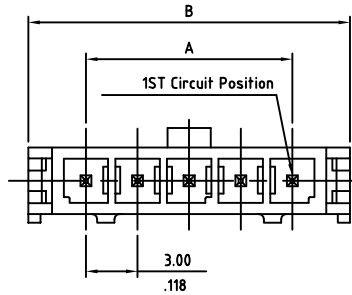

Recommended P.C. Board layout

THESE DRAWINGS AND SPECIFICATIONS ARE THE PROPERTY OF ON-SHORE TECHNOLOGY, INC. AND SHALL NOT BE REPRODUCED, COPIED OR USED IN ANY MANNER WITHOUT THE PRIOR WRITTEN CONSENT OF ON-SHORE TECHNOLOGY, INC.



TITLE		300HBT1V series, 3.00mm latch'n lock, vertical, dip solder header, single row, with pegs					
PART NO.		300HBT1VXX (xx - circuits)		DWG NO.		300HBT1VXX.DWG	
APPROVED		CHECKED	DESIGNED	DRAWN	4050		
Sam 2005.12.14		Tony 2005.12.14	Ralph 2005.12.14	Lin 2005.12.14	Tolerance		
						UNIT: mm/inches	X. ±0.30/.012
						SCALE: NONE	X.X ±0.20/.008
						REV: A	X.XX ±0.10/.004
						SHEET: 01/01	X° ±1°