

SIGN	DATE	DESCRIPTION	APPROVER
			Tony
THIS IS CAD DRAWING, DO NOT REVISE MANUALLY!!!			

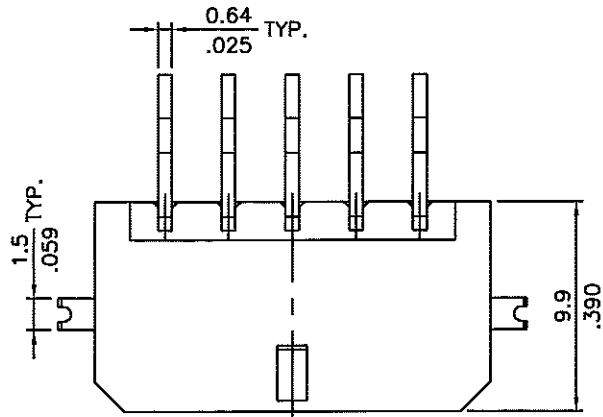

CIRCUITS	DIM. A	DIM. B
02	—	6.7(.264)
04	3.00(.118)	9.7(.382)
06	6.00(.236)	12.7(.500)
08	9.00(.354)	15.7(.618)
10	12.00(.472)	18.7(.736)
12	15.00(.591)	21.7(.854)
14	18.00(.709)	24.7(.972)
16	21.00(.827)	27.7(1.091)
18	24.00(.945)	30.7(1.209)
20	27.00(1.063)	33.7(1.327)
22	30.00(1.181)	36.7(1.445)
24	33.00(1.299)	39.7(1.563)

SPECIFICATIONS

Body: Nylon 6T
 Color: Black
 Flammability: UL94V-0
 Current: 5A for AWG#20-22
 4A for AWG#24
 2A for AWG#26
 1A for AWG#28-30
 Voltage: 250V AC(r.m.s.)
 Dielectric Withstanding: 1500 VAC for one minute
 Insulation Resistance: >1000 MΩ
 Contact Resistance: <10 mΩ
 Operating Temperature: -40°C ± 105°C
 Soldering Time: 20 seconds maximum
 Soldering Pot: 250°C-260°C

RoHS Compliant

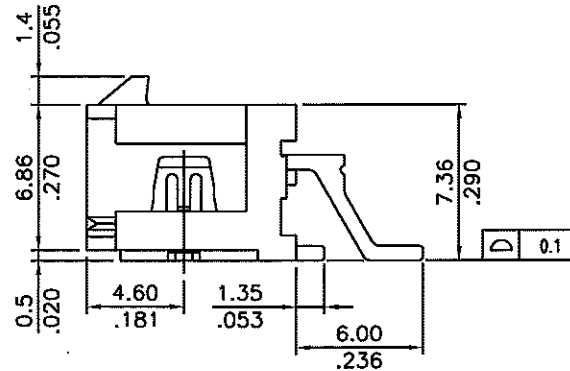
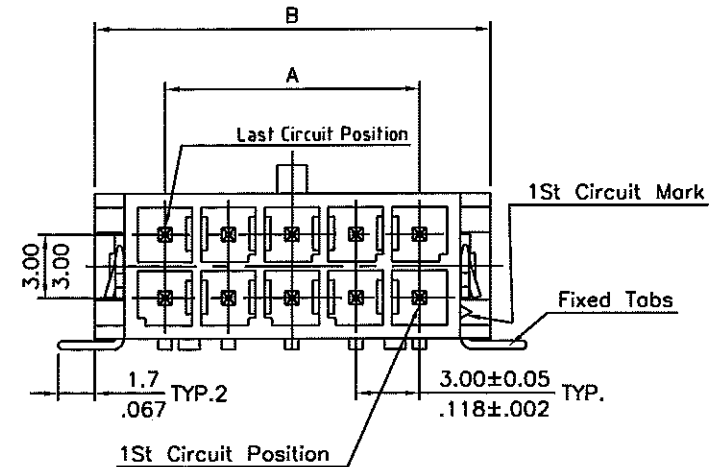

THESE DRAWINGS AND SPECIFICATIONS ARE THE PROPERTY OF ON-SHORE TECHNOLOGY, INC. AND SHALL NOT BE REPRODUCED, COPIED OR USED IN ANY MANNER WITHOUT THE PRIOR WRITTEN CONSENT OF ON-SHORE TECHNOLOGY, INC.

ON-SHORE TECHNOLOGY, INC.

TITLE				300HBS2R Series - 3.00mm latch'n lock, side entry, dual row, board side housing, SMT, fixed tabs			
PART NO.		300HBS2RXXF (xx - circuits)		DWG NO.		300HBS2RXXF.DWG	
APPROVED		CHECKED		DESIGNED		DRAWN	
				Tony 2006.02.07		Tony 2006.02.07	
				4050		Tolerance	
						UNIT: mm./inches SCALE: NONE REV: A	
				SHEET: 01/03		X ±0.30/.012 X.X ±0.20/.008 X.XX ±0.10/.004 X* ±1*	

SIGN	DATE	DESCRIPTION	APPROVER
			Tony

THIS IS CAD DRAWING, DO NOT REVISE MANUALLY!!!

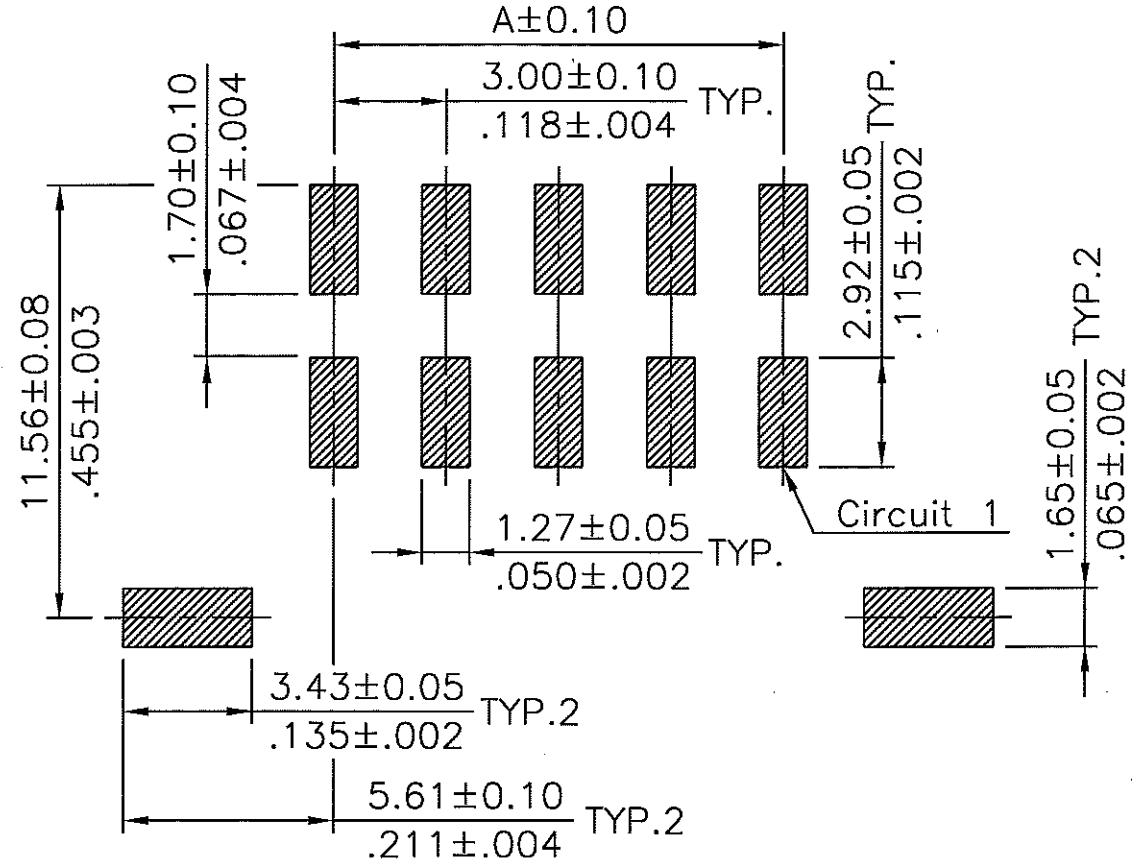

Recommended P.C. Board Layout

THESE DRAWINGS AND SPECIFICATIONS ARE THE PROPERTY OF ON-SHORE TECHNOLOGY, INC. AND SHALL NOT BE REPRODUCED, COPIED OR USED IN ANY MANNER WITHOUT THE PRIOR WRITTEN CONSENT OF ON-SHORE TECHNOLOGY, INC.



ON-SHORE TECHNOLOGY, INC.

TITLE	300HBS2R Series - 3.00mm latch'n lock, side entry, dual row board side housing, SMT, fixed tabs																
PART NO.	300HBS2RXXF	(xx - circuits)	DWG NO.	300HBS2RXXF.DWG													
APPROVED	CHECKED	DESIGNED	DRAWN	4050													
		Tony 2006.02.07	Tony 2006.02.07	Tolerance													
				<table border="1"> <tr> <td>UNIT: mm./inches</td> <td>X</td> <td>±0.30/.012</td> </tr> <tr> <td>SCALE: NONE</td> <td>XX</td> <td>±0.20/.008</td> </tr> <tr> <td>REV: A</td> <td>XXX</td> <td>±0.10/.004</td> </tr> <tr> <td></td> <td>X*</td> <td>±1°</td> </tr> </table>		UNIT: mm./inches	X	±0.30/.012	SCALE: NONE	XX	±0.20/.008	REV: A	XXX	±0.10/.004		X*	±1°
UNIT: mm./inches	X	±0.30/.012															
SCALE: NONE	XX	±0.20/.008															
REV: A	XXX	±0.10/.004															
	X*	±1°															
				SHEET: 02/03													

SIGN	DATE	DESCRIPTION	APPROVER
			Tony
THIS IS CAD DRAWING, DO NOT REVISE MANUALLY!!!			

NOTE :

- * Reel Material : HIPS
- * Carrier Material : Transparent,Conductive Polystyrene Alloy
- * Cover Tape Material : Polyester
- * Cover Tape Peel Strength : 0.1N – 1.3N
- * Carrier camber is within 1mm in 250mm
- * All dimensions meet EIA-481-B requirements.
- * Quantity : 250 PCS/Reel

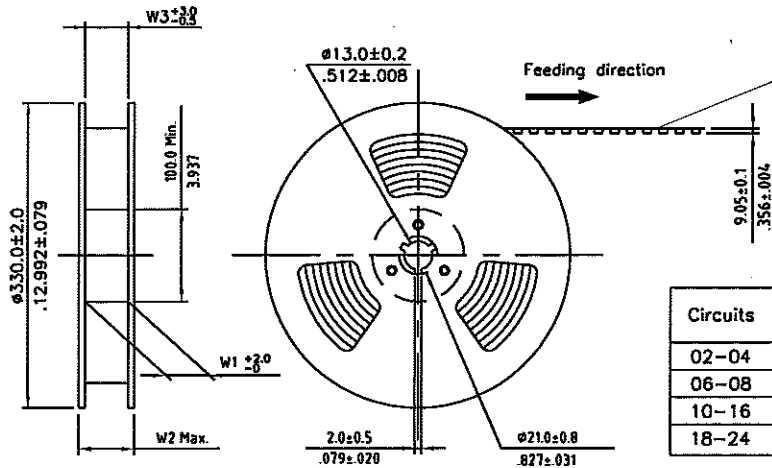

Circuits	Dimension					Packing (Reel/Caton)
	E	F	W1	W2	W3	
02-04	24.0(.945)	-	24.5(.965)	30.5(1.200)	24.5(.965)	9
06-08	32.0(1.260)	28.40(1.118)	32.5(1.280)	38.5(1.516)	32.5(1.280)	7
10-16	44.0(1.732)	40.40(1.596)	44.5(1.752)	50.5(1.988)	44.5(1.752)	5
18-24	56.0(2.205)	52.40(2.063)	56.5(2.224)	62.5(2.461)	56.5(2.224)	3

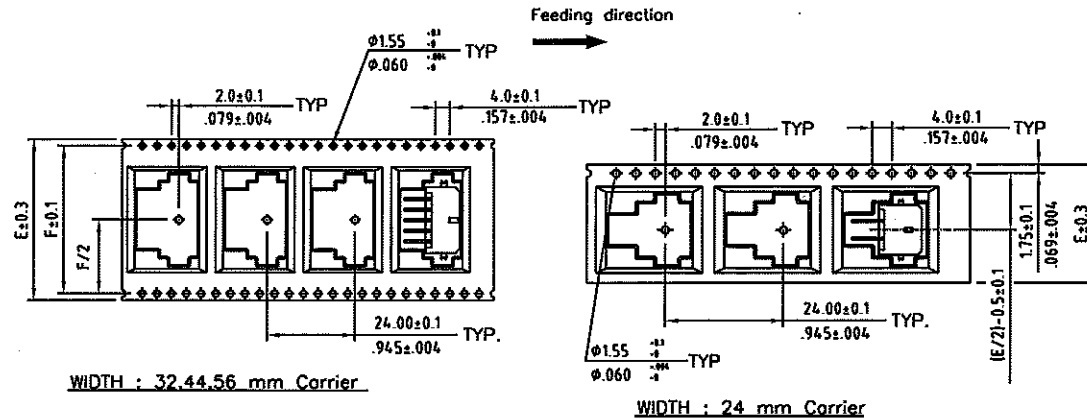
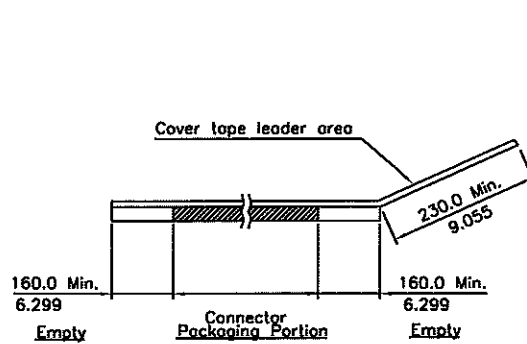

THESE DRAWINGS AND SPECIFICATIONS ARE THE PROPERTY OF ON-SHORE TECHNOLOGY, INC. AND SHALL NOT BE REPRODUCED, COPIED OR USED IN ANY MANNER WITHOUT THE PRIOR WRITTEN CONSENT OF ON-SHORE TECHNOLOGY, INC.

OST ON-SHORE TECHNOLOGY, INC.

TITLE	300HBS2R Series - 3.00mm latch'n lock, side entry, dual row board side housing, SMT, fixed tabs				
PART NO.	300HBS2RXXF	(xx - circuits)	DWG NO.	300HBS2RXXF.DWG	
APPROVED	CHECKED	DESIGNED	DRAWN	4050	
		Tony 2006.02.07	Tony 2006.02.07	Tolerance	
				UNIT: mm./inches	X .030/.012
				SCALE: NONE	XX .020/.008
				SHEET: 03/03	XXX .010/.004
				REV: A	X" ±1"